

LEGAL DESCRIPTION:

CLASS:

-----		CSR'S	.00	CODE	VALUE ACRES
GROSS	CURRENT				
ROADS	LAND	20,620			
D.D.	BLDG				
R.R.	DWLG	110,090(1)			
MISC					
	TOTAL	130,710			
NET					

30-91-37 R RESIDENTIAL
 ALTA WASHINGTON
 ST. ANDREWS COURT
 APT. #6

=====		YEAR	2009		
	LAND	20,620			
	BLDG				
	DWLG	110,090(1)			
	TOTAL	130,710			
	NET TX				

DEED HOLDER:	DATE REFER	CONTRACT HOLDER:	DATE REFER	YEAR	2008
ZYLSTRA LAYTON	05062009 2			LAND	22,210
ZYLSTRA REBECCA M				BLDG	
198 CASINO RD				DWLG	127,160(1)
STORM LAKE IA 50588				TOTAL	149,370
				NET TX	

				YEAR	2007
MC KENNA J ORTON	1			LAND	22,210
MC KENNA LEATRICE J				BLDG	
6 ST ANDREWS CT				DWLG	127,160(1)
ALTA IA 51002				TOTAL	149,370
				NET TX	

				YEAR	2007
				LAND	18,820
				BLDG	
				DWLG	107,760(1)
				TOTAL	126,580
				NET TX	

				YEAR	2006
				LAND	18,820
				BLDG	
				DWLG	107,760(1)
				TOTAL	126,580
				NET TX	

				YEAR	2005
				LAND	18,820
				BLDG	
				DWLG	107,760(1)
				TOTAL	126,580
				NET TX	

REMARKS:

1 W.D. 53/449 05-07-84 \$71,500
 2 W.D. #090643 02-25-09 \$120,000(D000)

PDF+PIN: 011+10-30-352-006 Deed: ZYLSTRA LAYTON,ZYLSTRA REBECCA M Map Area: WASH-RES(LAKE CREEK) Checks/Tags:
 Address 6 ST ANDREWS CT Contract: Route: 910-003-460 Lister/Date: LF, 08/11/2008
 (Property) CID#: 0980460 Tax Dist: ALTA WASHINGTON (LAKE CI Review/Date: DS, 12/09/2008
 City: ALTA DBA: Plat Page: - Entry Status: Inspected
RURAL/RESIDENTIAL MLS: Subdiv: [NONE]
 Legal: Section: ; Block: ; Lot: ; Twp: ; Rng: ; Deeded Acres: 0.000
 30-91-37 ALTA WASHINGTON ST. ANDREWS COURT APT. #6

Land									
Land Basis	Front	Rear	Side 1	Side 2	R. Lot	SF	Acres		
SqFt X Rate						8,247.00	0.189		
Grand Total						8,247.00	0.189		

Sales				Building Permits				Values			
Date	\$ Amount	NUTC	Recording	Date	Number	Tag	\$ Amount	Reason			
02/25/2009	\$120,000	D000	090643								
05/07/1984	\$71,500	D000									

Res. Structure		Finish				Plumbing				Addition		Garage	
Occ. Code	113	Ttl Rooms Above #	4	Bedrooms Above #	2	Full Bath	1	Addition	No Additions	Garage	1 of 1		
Occ. Descr.	Condominium	Ttl Rooms Below #	0	Bedrooms Below #	0	Shower Stall Bath	1	Year Built		Style	Att Brick		
Year Built	1983	Bsmt Fin Area #1				Toilet Room		EFA		W X L	0' X 0'		
EFA / EFYr	26 / 1983	Bsmt Fin Area #2				Lavatory		EFA Year		Area (SF)	400		
Arch. Dsgn	N/A	Bsmt Fin Area #3				Water Closet		Style		Year Built	1983		
Style	1 Story Brick	Foundation	POURED CONCRETE			Sink		Area (SF)		EFA	26		
AreaSF/TLA	1,400 / 1,400	Exterior Walls	BRICK VANNER			Shower Stall/Tub		Condition		EFF Year	1983		
Condition	NML	Roof	Asph / Gable			Mtl St Sh Bath				Condition	NML		
Basement	None	Interior Finish	Drwl			Mtl Stall Shower		Bsmt (SF)		Bsmt (SF)			
No Bsmt Flr.	0	Flooring	Carp / Ceramic			No Bathroom		NoBsmt Flr(SF)		Qtrs Over	None		
Heat	FHA - Gas	Non-base Heating		Fireplace		Wet Bar		Heat		Qtrs Over (SF)			
AC	Yes	Floor/Wall #	0	Masonry, 1 Sty	1	Whirlpool Bathroom		AC		Qtrs AC (SF)			
Attic	None	Pipeless #	0			Whirlpool Tub		Attic (SF)					
		Hand Fired (Y/N)	No			No Hot Water Tank							
		Space Heat #	0			No Plumbing							
		Appliances				Sewer & Water Only				Door Opnrs	1		
		Range Unit	Built-In Vacuums			Water Only w/Sink				Bsmt Stalls			
		Oven - Single	Intercom System			Hot Tub							
		Oven - Double	BI Stereo			Bidet							
		Dishwasher				Fbgl Service Sink							
		Microwave				Urinal							
		Trash Compactor				Sauna							
		Jennair				W'Pool Bath w/Shower							
		Security System				Water Only							
						No Tub/Shower							

Bldg / Addn	Description	Units	Year					
1 of 1	113 — Condominium							
	1 Story Brick	1,400						
	Adjustment for basement - None							
	Base Heat: FHA - Gas							
	Add Central Air	1,400						
	Deck #1: Concrete Patio-Med	250 SF						
	Plumbing	2						
#1	Fireplace: Masonry, 1 Story	1						
	Garage: Att Brick	400 SF	1983					

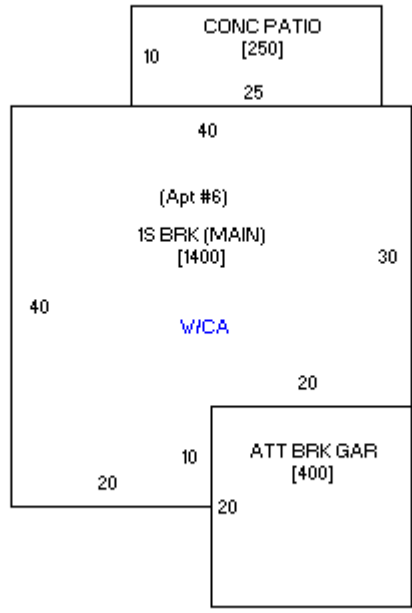



08/18/2008



05/01/1998