

LEGAL DESCRIPTION:

CLASS:

30-91-37 R RESIDENTIAL  
 ALTA WASHINGTON  
 AUD S/D SW FR 1/4  
 LOT 24 & PARCEL 5' X  
 100' ADJ. TO LOT 24

-----		CSR'S	.00	-----	
				CODE	VALUE ACRES
GROSS	CURRENT				
ROADS	LAND	37,800			
D.D.	BLDG				
R.R.	DWLG	146,180( 1)			
MISC					
	TOTAL	183,980			
NET					

=====		=====	=====	=====	
	YEAR	2009			
	LAND	37,800			
	BLDG				
	DWLG	146,180( 1)			
	TOTAL	183,980			
	NET TX				

-----		DEED HOLDER:	DATE REFER	CONTRACT HOLDER:	DATE REFER	YEAR	2008	-----	
		QUIRIN EDWARD C	08212009 6			LAND	40,090		
		QUIRIN CHARLENE W				BLDG			
		825 E MILWAUKEE				DWLG	154,530( 1)		
		STORM LAKE IA 50588				TOTAL	194,620		
						NET TX			

-----		DEED HOLDER:	DATE REFER	CONTRACT HOLDER:	DATE REFER	YEAR	2007	-----	
		SMITH TIMOTHY J	01272004 5			LAND	40,090		
		SMITH ERIN M				BLDG			
		24 ST ANDREWS DR				DWLG	154,530( 1)		
		STORM LAKE IA 50588				TOTAL	194,620		
						NET TX			

-----		DEED HOLDER:	DATE REFER	CONTRACT HOLDER:	DATE REFER	YEAR	2007	-----	
		JENSEN NANCY C	02132002 4			LAND	33,970		
		139 MALLARD				BLDG			
		STORM LAKE IA				DWLG	130,960( 1)		
						TOTAL	164,930		
						NET TX			

-----		DEED HOLDER:	DATE REFER	CONTRACT HOLDER:	DATE REFER	YEAR	2006	-----	
		JOHNSON NANCY C	3			LAND	33,970		
		24 ST ANDREWS DR				BLDG			
		STORM LAKE IA				DWLG	130,960( 1)		
						TOTAL	164,930		
						NET TX			

-----		REMARKS:	DATE REFER	CONTRACT HOLDER:	DATE REFER	YEAR	2006	-----	
		3 W.D. #002392 08-30-00 \$156,000(D000)				LAND	33,970		
		4 AFFIDAVIT #020024 01-03-02				BLDG			
		5 W.D. #035536 12-24-03 \$135,000 (D000)				DWLG	130,960( 1)		
		6 W.D. #092395 07-31-09 \$150,000 (D000)				TOTAL	164,930		
						NET TX			

-----		REMARKS:	DATE REFER	CONTRACT HOLDER:	DATE REFER	YEAR	2005	-----	
						LAND	33,970		
						BLDG			
						DWLG	130,960( 1)		
						TOTAL	164,930		
						NET TX			



Res. Structure		Finish				Plumbing		Addition		Garage	
Occ. Code	101	Ttl Rooms Above #	6	Bedrooms Above #	3	Full Bath	1	Addition	No Additions	Garage	1 of 1
Occ. Descr.	Single-Family / Owner Occupied	Ttl Rooms Below #	0	Bedrooms Below #	0	Shower Stall Bath	1	Year Built		Style	Att Frm
Year Built	1977	Bsmt Fin Area #1				Toilet Room	1	EFA		W X L	0' X 0'
EFA / EFYr	32 / 1977	Bsmt Fin Area #2				Lavatory		EFA Year		Area (SF)	528
Arch. Dsgn	N/A	Bsmt Fin Area #3				Water Closet		Style		Year Built	1977
Style	1 Story Frame	Foundation	C Blk			Sink	1	Area (SF)		EFA	32
AreaSF/TLA	1,812 / 1,812	Exterior Walls	Stl			Shower Stall/Tub		Condition		EFF Year	1977
Condition	V Good	Roof	Asph / Gable			Mtl St Sh Bath		Bsmt (SF)		Condition	V Good
Basement	None	Interior Finish	Drwl			Mtl Stall Shower		NoBsmt Flr(SF)		Bsmt (SF)	
No Bsmt Flr.	0	Flooring	Carp / Ceramic			No Bathroom		Heat		Qtrs Over	None
Heat	FHA - Gas	<b>Non-base Heating</b>		<b>Fireplace</b>		Wet Bar		AC		Qtrs Over (SF)	
AC	Yes	Floor/Wall #	0	Prefab, 1 Sty	1	Whirlpool Bathroom		Attic (SF)		Qtrs AC (SF)	
Attic	None	Pipeless #	0			Whirlpool Tub				Door Opnrs	
		Hand Fired (Y/N)	No			No Hot Water Tank				Bsmt Stalls	
		Space Heat #	0			No Plumbing					
						Sewer & Water Only					
		<b>Appliances</b>				Water Only w/Sink					
		Range Unit	Built-In Vacuums			Hot Tub					
		Oven - Single	Intercom System			Bidet					
		Oven - Double	Bl Stereo			FbglS Service Sink					
		Dishwasher				Urinal					
		Microwave				Sauna					
		Trash Compactor				W'Pool Bath w/Shower					
		Jennair				Water Only					
		Security System				No Tub/Shower					



Bldg / Addn	Description	Units	Year
1 of 1	101 — Single-Family / Owner Occupied		
	1 Story Frame	1,812	
	Adjustment for basement - None		
	Base Heat: FHA - Gas		
	Add Central Air	1,812	
#1	Porch: 1S Frame Open	120 SF	
#2	Porch: 1S Frame Enclosed	176 SF	
	Deck #1: Concrete Patio-Low	676 SF	
	Deck #2: Asph/Wd Roof OH-Med	132 SF	
	Plumbing	4	
#1	Fireplace: Prefab, 1 Story	1	
	Garage: Att Frame	528 SF	1977

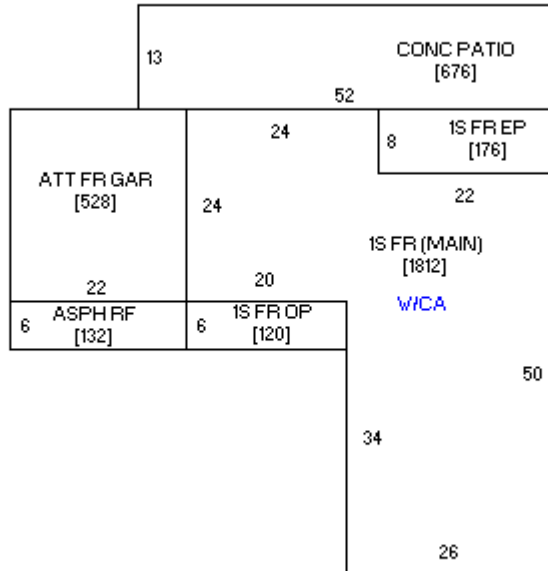



08/18/2008



09/11/1997