

Pin: 04-22-100-002  
Sale Date: 09/12/09  
Sale Price: \$80,000  
Acres: 4.12 Net  
Classification: Change in use from  
Ag Dwlg to Rural Residential

04-22-100-002

#8095.50

R-Res



LEGAL DESCRIPTION:

CLASS:

22-93-35 A AGRICULTURE  
LAUR. MARA. POLAND  
PT IN NW NW

-----		CSR'S	315.00		
				CODE	VALUE ACRES
GROSS	4.49	CURRENT			
ROADS	.37	LAND	5,530		
D.D.		BLDG	3,790( 4)		
R.R.		DWLG	91,320( 1)		
MISC					
		TOTAL	100,640		
NET	4.12				

=====		=====		=====	
		YEAR	2009		
		LAND	5,530	ROAD	.37
		BLDG	3,790( 4)		
		DWLG	91,320( 1)		
		TOTAL	100,640		
		NET TX			

-----		-----		-----	
DEED HOLDER:	DATE REFER	CONTRACT HOLDER:	DATE REFER	YEAR	2008
				LAND	3,390
GROW MELODY L	11182009 4			BLDG	7,370( 4)
203 N MINERVA				DWLG	81,700( 1)
P O BOX 16				TOTAL	92,460
MARATHON IA 50565-0016				NET TX	

-----		-----		-----	
				YEAR	2007
HOWE CASSIUS	12022008 3			LAND	3,390
KONZ CORYNE HOWE				BLDG	7,370( 4)
27378 POLK AVE				DWLG	81,700( 1)
KINGSLEY IA 51028				TOTAL	92,460
				NET TX	

-----		-----		-----	
				YEAR	2007
HOWE JERRY L LIFE ESTATE	12022008 2			LAND	2,760
HOWE CASSIUS				BLDG	7,370( 4)
KONZ CORYNE HOWE				DWLG	69,240( 1)
				TOTAL	79,370
HOWE NYLE D	1			NET TX	

-----		-----		-----	
				YEAR	2006
REMARKS:				LAND	2,760
				BLDG	7,370( 4)
1 W.D. 50/62 10-24-77 (survey 31/3)				DWLG	69,240( 1)
2 CHG TITLE 56/533 05-15-89				TOTAL	79,370
3 W.D.#083280 10-28-08 \$2,000				NET TX	
4 W.D. #093065 09-12-09 \$80,000 (D000)					

-----		-----		-----	
				YEAR	2005
				LAND	2,760
				BLDG	7,370( 4)
				DWLG	69,240( 1)
				TOTAL	79,370
				NET TX	

4516 220TH AVE, 0

Deed: **GROW MELODY L**

Map Area: **POLAND-RES**

Checks/Tags:

Contract:

Route: **904-001-630**

Lister/Date: **AP, 07/15/2008**

CID#: **0809550**

Tax Dist: **L-M POLAND**

Review/Date: **DS, 10/22/2008**

DBA:

Plat Page: -

Entry Status: **Inspected**

MLS:

Subdiv: **[NONE]**

**RURAL/RESIDENTIAL**

Legal: 22-93-35 LAUR. MARA. POLAND PT IN NW NW

Land									
Land Basis	Front	Rear	Side 1	Side 2	R. Lot	SF	Acres		
<b>Site-Excess</b>							1.000		
Excess 1							3.120		
Sub Total						179,467.20	4.120		
<b>Grand Total</b>						179,467.20	4.120		

Sales				Building Permits				Values			
Date	\$ Amount	NUTC	Recording	Date	Number	Tag	\$ Amount	Reason			
09/12/2009	\$80,000	D15	093065								
10/28/2008	\$2,000	D017	083280								

Res. Structure		Finish				Plumbing		Addition		Garage	
Occ. Code	101	Ttl Rooms Above #	5	Bedrooms Above #	3	Full Bath	2	Addition	No Additions	Garage	1 of 1
Occ. Descr.	Single-Family / Owner Occupied	Ttl Rooms Below #	0	Bedrooms Below #	0	Shower Stall Bath		Year Built		Style	Att Frm
Year Built	1978	Bsmt Fin Area #1				Toilet Room		EFA		W X L	0' X 0'
EFA / EFYr	31 / 1978	Bsmt Fin Area #2				Lavatory		EFA Year		Area (SF)	576
Arch. Dsgn	N/A	Bsmt Fin Area #3				Water Closet		Style		Year Built	1978
Style	1 Story Frame	Foundation	C Blk			Sink		Area (SF)		EFA	31
AreaSF/TLA	1,560 / 1,560	Exterior Walls	Wd Lap			Shower Stall/Tub		Condition		EFF Year	1978
Condition	NML	Roof	Asph / Gable			Mtl St Sh Bath					
Basement	Full	Interior Finish	Drwl			Mtl Stall Shower		Bsmt (SF)		Condition	NML
No Bsmt Flr.	0	Flooring	Carp / Vinyl			No Bathroom		NoBsmt Flr(SF)		Bsmt (SF)	
Heat	FHA - Gas	<b>Non-base Heating</b>		<b>Fireplace</b>		Wet Bar		Heat		Qtrs Over	None
AC	Yes	Floor/Wall #	0			Whirlpool Bathroom		AC		Qtrs Over (SF)	
Attic	None	Pipeless #	0			Whirlpool Tub		Attic (SF)		Qtrs AC (SF)	
		Hand Fired (Y/N)	No			No Hot Water Tank				Door Opnrs	
		Space Heat #	0			No Plumbing				Bsmt Stalls	
		<b>Appliances</b>				Sewer & Water Only					
		Range Unit	Built-In Vacuums			Water Only w/Sink					
		Oven - Single	Intercom System			Hot Tub					
		Oven - Double	Bl Stereo			Bidet					
		Dishwasher				Fbgls Service Sink					
		Microwave				Urinal					
		Trash Compactor				Sauna					
		Jennair				W'Pool Bath w/Shower					
		Security System				Water Only					
						No Tub/Shower					



Bldg / Addn	Description	Units	Year					
1 of 1	101 — Single-Family / Owner Occupied							
	1 Story Frame	1,560						
	Base Heat: FHA - Gas							
	Add Central Air	1,560						
#1	Porch: 1S Frame Enclosed	288 SF						
	Plumbing	2						
	Garage: Att Frame	576 SF	1978					

	Count	Ag Building Description	Units		Year					
1 of 4 P:1	1	GOVT 904-Bin - Stl. Grain Storage	16' X 16'	2,740 Bu	1900					
2 of 4 P:2	1	FR @ .40 906-Barn - Flat	32' X 64'	2,048 SF	1900					
3 of 4 P:3	1	GARAGE FR @ .26 927-Shed	22' X 24'	528 SF	1900					
4 of 4 P:4	1	MTL POLE 925-Steel Utility Bldg	50' X 90'	4,500 SF	1978					

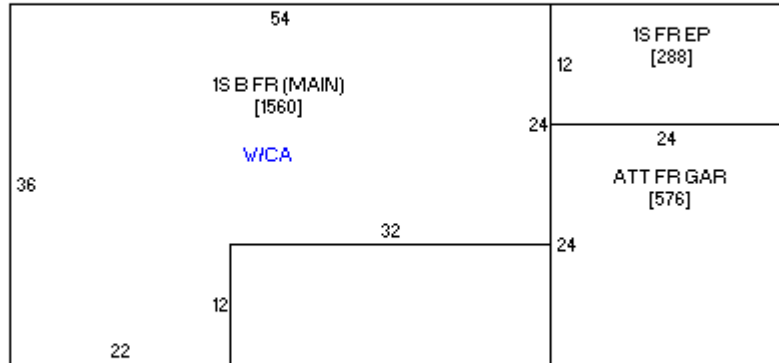



08/25/2008