

16-18-100-002

#7311.50

R-Res

N  
↑

Pin: 16-18-100-002  
Sale Date: 10/15/08  
Sale Price: \$110,000  
Acres: 3.25 Net  
Classification: Rural Residential

See picture of barrel shed next page

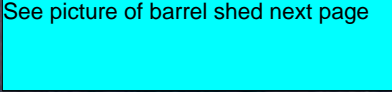

#9 - Barrel Shed

Main shed  
6

09

#8 - Barrel Shed

02

3

G



#7 - Barrel Shed  
07

5 02





02.01.2007

LEGAL DESCRIPTION:

CLASS:

18-90-35  
NEWELL PROV. NEWELL  
3.48 A IN NW NW

R RESIDENTIAL

		CSR'S	.00		
				CODE	VALUE ACRES
GROSS	3.48	CURRENT			
ROADS	.23	LAND	12,000		
D.D.		BLDG			
R.R.		DWLG	45,680( 1)		
MISC					
		TOTAL	57,680		
NET	3.25				

		YEAR	2008		
		LAND	12,000	ROAD	.23
		BLDG			
		DWLG	45,680( 1)		
		TOTAL	57,680		
		NET TX			

DEED HOLDER:	DATE REFER	CONTRACT HOLDER:	DATE REFER	YEAR	2007		
ERICKSON JASON J	10292008 3			LAND	12,000	ROAD	.23
ERICKSON DANA K				BLDG			
6224 190TH AVE				DWLG	45,680( 1)		
NEWELL IA 50568				TOTAL	57,680		
				NET TX			

DEED HOLDER:	DATE REFER	CONTRACT HOLDER:	DATE REFER	YEAR	2007		
COLSHAN RICHARD F	07271998 2	..		LAND	10,170	ROAD	.23
COLSHAN LORETTA L				BLDG			
6224 190TH AVE				DWLG	38,710( 1)		
NEWELL IA 50568				TOTAL	48,880		
				NET TX			

DEED HOLDER:	DATE REFER	CONTRACT HOLDER:	DATE REFER	YEAR	2006		
BODHOLDT JUANITA	07241998	COLSHAN RICHARD F	1	LAND	10,170	ROAD	.23
		6224 190TH AVE		BLDG			
		NEWELL IA		DWLG	38,690( 1)		
				TOTAL	48,860		
				NET TX			

DEED HOLDER:	DATE REFER	CONTRACT HOLDER:	DATE REFER	YEAR	2005		
BODHOLDT JUANITA		COLSHAN RICHARD F		LAND	10,170	ROAD	.23
		COLSHAN ROBERTA J		BLDG			
		R R		DWLG	38,690( 1)		
		NEWELL IA		TOTAL	48,860		
				NET TX			

REMARKS:	YEAR	2005		
1 AFF 10/786 09-03-93	LAND	10,170	ROAD	.23
2 W.D. #982401 07-19-88 (D022)	BLDG			
3 WD #082917-18 10-15-08 \$110,000	DWLG	38,690( 1)		
	TOTAL	48,860		
	NET TX			

YEAR	2004		
LAND	10,170		
BLDG			
DWLG	37,870( 1)		
TOTAL	48,040		
NET TX			

PDF+PIN: 011+16-18-100-002 Deed: **ERICKSON JASON J,ERICKSON DANA K** Map Area: **380 N-P NEWELL** Checks/Tags:  
 Address **6224 190TH AVE** Contract: Route: **000-000-000** Lister/Date: **KAC, 02/25/2005**  
 (Property) CID#: **0731150** Tax Dist: **NEWELL-PROV.** Review/Date:  
 City: DBA: Plat Page: - Entry Status: **Inspected**  
**RURAL/RESIDENTIAL** MLS: Subdiv: **[NONE]**  
 Legal: Section: ; Block: ; Lot: ; Twp: ; Rng: ; Deeded Acres: 0.000  
 18-90-35 NEWELL PROV. NEWELL 3.48 A IN NW NW

Land										
Land Basis	Front	Rear	Side 1	Side 2	R. Lot	SF	Acres	Depth Factor	EFF	Qual./Land
<b>Acres X Rate</b>						43,560.00	1.000			AC-4
<b>Acres X Rate</b>						98,010.00	2.250			AC-1
<b>Grand Total</b>						141,570.00	3.250			

Sales				Building Permits				Values			
Date	\$ Amount	NUTC	Recording	Date	Number	Tag	\$ Amount	Reason			
10/15/2008	\$110,000	D000	082917								
06/15/1988	\$25,000	C000									

Res. Structure 1 of 1		Finish				Plumbing				Addition		Garage	
Occ. Code	101	Ttl Rooms Above #	0	Bedrooms Above #	4	Full Bath	1	Addition	No Additions	Garage	1 of 1		
Occ. Descr.	Single-Family / Owner Occupied	Ttl Rooms Below #	0	Bedrooms Below #	0	Shower Stall Bath		Year Built		Style	Det Frm		
Year Built	1930	Bsmt Fin Area #1				Toilet Room		EFA		W X L	24' X 24'		
EFA / EFYr	71 / 1930	Bsmt Fin Area #2				Lavatory		EFA Year		Area (SF)	576		
Arch. Dsgn	N/A	Bsmt Fin Area #3				Water Closet		Style		Year Built	1969		
Style	1 1/2 Story Frame	Foundation	C Bk			Sink		Area (SF)		EFA	32		
AreaSF/TLA	780 / 1,326	Exterior Walls	Wd Lap			Shower Stall/Tub		Condition		EFF Year	1969		
Condition	BL NML	Roof	Asph / Gable			Mtl St Sh Bath							
Basement	Full	Interior Finish	PLASTER/SOFT-PLAST/SOFT			Mtl Stall Shower		Bsmt (SF)		Condition	NML		
No Bsmt Flr.	0	Flooring	CONC-HARDWOOD-HARDWOD			No Bathroom		NoBsmt Flr(SF)		Bsmt (SF)			
Heat	FHA - Gas	<b>Non-base Heating</b>		<b>Fireplace</b>		Wet Bar		Heat		Qtrs Over	None		
AC	Yes	Floor/Wall #	0			Whirlpool Bathroom		AC		Qtrs Over (SF)			
Attic	None	Pipeless #	0			Whirlpool Tub		Attic (SF)		Qtrs AC (SF)			
		Hand Fired (Y/N)	No			No Hot Water Tank							
		Space Heat #	0			No Plumbing							
		<b>Appliances</b>				Sewer & Water Only				Door Opnrs			
		Range Unit	Intercom System			Water Only w/Sink				Bsmt Stalls			
		Oven Unit	Intercom w/Music			Hot Tub							
		Dishwasher	Built-In Stereo			Water Only							
		Microwave	Bl Stereo(SpkrsOnly)			No Tub / Shower							
		Trash Compactor	Security System			Urinal							
		Jennair				Bidet							
		B.I. Bar-B-Que				FbglS Service Sink							
		Built-In Vacuums											

Bldg / Addn	Description	Units	Year					
1 of 1	101 — Single-Family / Owner Occupied							
	1 1/2 Story Frame	780						
	Base Heat: FHA - Gas							
	Add Central Air	780						
#1	Porch: 1S Frame Enclosed	176 SF						
#2	Porch: 1S Frame Enclosed	155 SF						
	Deck #1: Wood Deck-Med	64 SF						
	Deck #2: Concrete Patio-Med	202 SF						
	Garage: Det Frame 24' X 24'	576 SF	1969					

	Count	Ag Building Description	Units	Year						
1 of 6 P:2	1	OPEN FR @ .90 927-Shed	18' X 40' 720 SF	1900						
2 of 6 P:3	1	MTL POLE 925-Steel Utility Bldg	36' X 36' 1,296 SF	1988						
3 of 6 P:6	1	FR @ .20 924-Machine or Utility Bldg	18' X 40' 720 SF	1978						
4 of 6 P:7	1	BARREL SHED @ SV 927-Shed	0' X 0' 0 SF	2006						
5 of 6 P:8	1	BARREL SHED @ SV 927-Shed	0' X 0' 0 SF	2006						
6 of 6 P:9	1	BARREL SHED @ SV 927-Shed	0' X 0' 0 SF	2006						

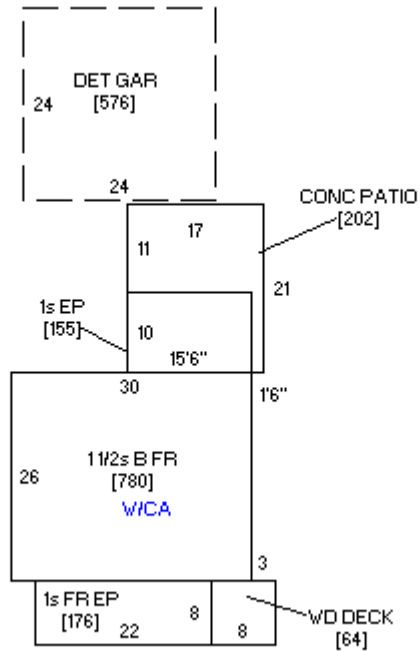



05/03/2007