

LEGAL DESCRIPTION:

CLASS:

01-00 R RESIDENTIAL
ALTA WASHINGTON
DREYS S/D OF LOT A
30-91-37

-----		CSR'S	.00	-----	
				CODE	VALUE ACRES
GROSS	CURRENT				
ROADS	LAND	49,940			
D.D.	BLDG				
R.R.	DWLG	308,850(1)			
MISC					
	TOTAL	358,790			
NET					

=====		=====	=====	=====	
	YEAR	2008			
	LAND	49,940			
	BLDG				
	DWLG	308,850(1)			
	TOTAL	358,790			
	NET TX				

-----		-----	-----	-----	-----
DEED HOLDER:	DATE REFER	CONTRACT HOLDER:	DATE REFER	YEAR	2007
JONES DANIEL R	10292008 4			LAND	49,940
JONES AMY JO				BLDG	
101 EVERGREEN DR				DWLG	308,850(1)
ALTA IA 51002				TOTAL	358,790
				NET TX	

-----		-----	-----	-----	-----
				YEAR	2007
MARTIN DOUGLAS R	11082006 3			LAND	42,320
MARTIN DEBRA R				BLDG	
516 E 12TH				DWLG	261,730(1)
STORM LAKE IA 50588				TOTAL	304,050

-----		-----	-----	-----	-----
				YEAR	2005 REFER: 1
DREY RANDY A	2			LAND	16,030
DREY DEBRA R				BLDG	
106 EVERGREEN DR				DWLG	
ALTA IA 51002				TOTAL	16,030
				NET TX	

-----		-----	-----	-----	-----
				YEAR	2005
REMARKS:				LAND	33,580
				BLDG	
1 05) SPLIT FROM 100-006 (03/08/05)				DWLG	
2 PLAT #050116 12/23/04				TOTAL	33,580
3 W.D. #053815 11-03-05 \$35,000 (D034)				NET TX	

-----		-----	-----	-----	-----
				YEAR	2006
				LAND	41,980
				BLDG	
				DWLG	44,940
				TOTAL	86,920
				NET TX	

PDF+PIN: 011+10-30-151-001 Deed: **JONES DANIEL R,JONES AMY JO** Map Area: **260 ALTA WASH** Checks/Tags:
 Address **101 EVERGREEN DR** Contract: Route: **000-000-000** Lister/Date: **CL, 02/16/2007**
 (Property) CID#: **0976450** Tax Dist: **ALTA** Review/Date: **CL, 02/20/2008**
 City: **ALTA** DBA: Plat Page: Entry Status: **Inspected**
RURAL/RESIDENTIAL MLS: Subdiv: **[NONE]**
 Legal: Section: ; Block: ; Lot: 01-00 ALTA WASHINGTO; Twp: ; Rng: ; Deeded Acres: 0.000
 01-00 ALTA WASHINGTON DREY'S S/D OF LOT A 30-91-37

Land											
Land Basis	Front	Rear	Side 1	Side 2	R. Lot	SF	Acres	Depth Factor	EFF	Qual./Land	
FF Main	150.00	150.00	340.00	340.00	0.00			1.24	186.00	R-270	
Sub Total						51,000.00	1.171				
Grand Total						51,000.00	1.171				

Sales				Building Permits				Values			
Date	\$ Amount	NUTC	Recording	Date	Number	Tag	\$ Amount	Reason			
10/09/2008	\$318,000	D000	082872	11/1/2005		Y	\$210,000	New Dwlg			
11/03/2005	\$35,000	D034	053815								

Res. Structure 1 of 1		Finish				Plumbing				Addition		Garage	
Occ. Code	101	Ttl Rooms Above #	8	Bedrooms Above #	3	Full Bath	1	Addition	No Additions	Garage	1 of 1		
Occ. Descr.	Single-Family / Owner Occupied	Ttl Rooms Below #	2	Bedrooms Below #	1	Shower Stall Bath	1	Year Built		Style	Att Frm		
Year Built	2006	Bsmt Fin Area #1	1350	Table		Toilet Room		EFA		W X L	0' X 0'		
EFA / EFYr	1 / 2006	Bsmt Fin Area #2				Lavatory	1	EFA Year		Area (SF)	726		
Arch. Dsgn	N/A	Bsmt Fin Area #3				Water Closet		Style		Year Built	2006		
Style	1 Story Frame	Foundation	Conc			Sink	1	Area (SF)		EFA	1		
AreaSF/TLA	2,175 / 2,175	Exterior Walls	Stl			Shower Stall/Tub	1	Condition		EFF Year	2006		
Condition	NML	Roof	Asph / Hip			Mtl St Sh Bath							
Basement	Full	Interior Finish	Drwl			Mtl Stall Shower		Bsmt (SF)		Condition	NML		
No Bsmt Flr.	0	Flooring	Carp / Vinyl			No Bathroom		NoBsmt Flr(SF)		Bsmt (SF)			
Heat	Yes	Non-base Heating		Fireplace		Wet Bar		Heat		Qtrs Over	None		
AC	Yes	Floor/Wall #	0	Gas/Elec-Side, 1 Sty	1	Whirlpool Bathroom	1	AC		Qtrs Over (SF)			
Attic	None	Pipeless #	0			Whirlpool Tub		Attic (SF)		Qtrs AC (SF)			
		Hand Fired (Y/N)	No			No Hot Water Tank							
		Space Heat #	0			No Plumbing							
		Appliances				Sewer & Water Only				Door Opnrs			
		Range Unit	Intercom System			Water Only w/Sink				Bsmt Stalls			
		Oven Unit	Intercom w/Music			Hot Tub							
		Dishwasher	Built-In Stereo			Water Only							
		Microwave	Bl Stereo(SpkrsOnly)			No Tub / Shower							
		Trash Compactor	Security System			Urinal							
		Jennair				Bidet							
		B.I. Bar-B-Que				Fbgl Service Sink	1						
		Built-In Vacuums											

Bldg / Addn	Description	Units	Year
1 of 1	101 — Single-Family / Owner Occupied		
	1 Story Frame	2,175	
#1	Bsmt Fin - Living Qtrs. (Multi) (Avg)	1,350 Tbl	
	Base Heat		
	Add Central Air	2,175	
#1	Porch: 1S Frame Open	85 SF	
	Veneer #1 1 Story Brick	51.0 LF	
	Plumbing	7	
#1	Fireplace: Gas/Elec-Side, 1 Story	1	
	Garage: Att Frame	726 SF	2006

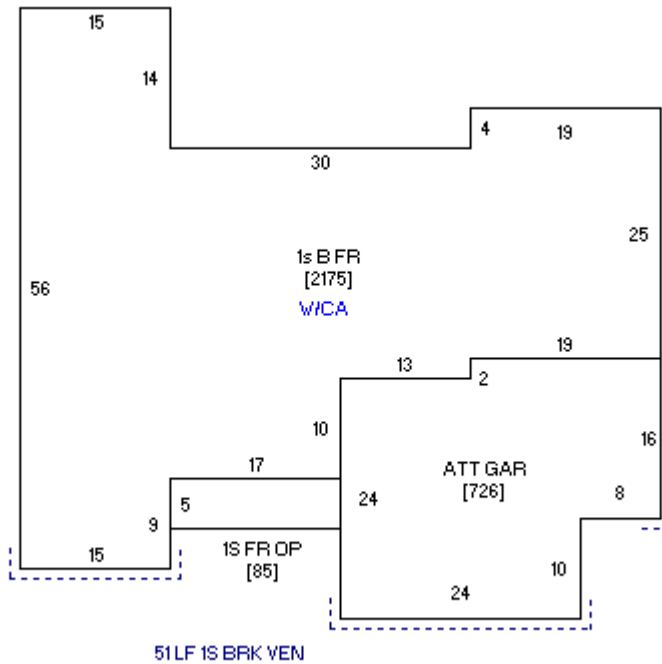



03/16/2006

Land Depreciation Notes:

Land basis 1: EXCESS