

LEGAL DESCRIPTION:

CLASS:

-----		CSR'S	.00	
				CODE VALUE ACRES
GROSS	CURRENT			
ROADS	LAND	63,520		
D.D.	BLDG			
R.R.	DWLG	212,810(1)		
MISC				
	TOTAL	276,330		
NET				
-----		-----		

05-06 R RESIDENTIAL
 STORM LAKE HAYES
 CASINO BEACH

-----		YEAR	2007	
		LAND	63,520	
		BLDG		
		DWLG	212,810(1)	
		TOTAL	276,330	
		NET TX		
-----		-----		

DEED HOLDER:	DATE REFER	CONTRACT HOLDER:	DATE REFER	YEAR	2007
BESCH THEODORE J	08202007 2			LAND	53,830
BESCH MARY L				BLDG	
136 SCOTT				DWLG	180,350(1)
STORM LAKE IA 50588				TOTAL	234,180
				NET TX	
-----		-----		-----	

KREBS SIDNEY F	1			YEAR	2006
KREBS JUDY K				LAND	53,830
194 CASINO RD				BLDG	
STORM LAKE IA 50588				DWLG	180,350(1)
				TOTAL	234,180
				NET TX	
-----		-----		-----	

				YEAR	2005
				LAND	53,830
				BLDG	
				DWLG	180,350(1)
				TOTAL	234,180
				NET TX	
-----		-----		-----	

				YEAR	2004
				LAND	53,830
				BLDG	
				DWLG	180,350(1)
				TOTAL	234,180
				NET TX	
-----		-----		-----	

REMARKS:
 1 WD 56/553 05-31-89 RE=31,500 PP=2,500
 2 W.D. #072066 06-05-07 \$320,000 (D000)

				YEAR	2003
				LAND	53,830
				BLDG	
				DWLG	180,350(1)
				TOTAL	234,180
				NET TX	3,428
-----		-----		-----	

PDF+PIN: 003+14-09-303-012 Deed: **BESCH THEODORE J,BESCH MARY L** Map Area: **542 CASINO** Checks/Tags:
 Address: **136 SCOTT ST** Contract: Route: **000-000-000** Lister/Date: **TG, 02/23/1993**
 City: CID#: **0949700** Tax Dist: **STORM LAKE** Review/Date:
RURAL/RESIDENTIAL DBA: Plat Page: - Entry Status: **Inspected**

Land														
Land Basis	Front	Rear	Side 1	Side 2	R. Lot	SF	Acres	Depth Factor	EFF	Qual./Land				
FF Main	45.00	45.00	91.00	88.00	0.00			0.86	38.70	R-1300				
Sub Total						4,027.50	0.093							
Grand Total						4,027.50	0.093							

Land Site Items

Front Foot | Street: None | Utilities: None | Zoning: Not Applicable

Sales				Building Permits				Values					
Date	\$ Amount	NUTC	Recording	Date	Number	Tag	\$ Amount	Reason					
05/31/1989	\$31,500	D000	056-553										
08/04/1984	\$25,000	D000											

Res. Structure		Finish				Plumbing				Addition				Garage	
Occ. Code	101	Ttl Rooms Above #	4	Bedrooms Above #	3	Full Bath	1	Addition	1 of 3	Garage	1 of 1				
Occ. Descr.	Single-Family / Owner Occupied	Ttl Rooms Below #	0	Bedrooms Below #	0	Shower Stall Bath	1	Year Built	1992	Style	Att Frm				
Year Built	1992	Bsmt Fin Area #1				Toilet Room	1	EFA	9	W X L	0' X 0'				
EFA / EFYr	9 / 1992	Bsmt Fin Area #2				Lavatory		EFA Year	1992	Area (SF)	469				
Arch. Dsgn	N/A	Bsmt Fin Area #3				Water Closet		Style	1 Sty Frm	Year Built	1992				
Style	2 Story Frame	Foundation	C Blk			Sink		Area (SF)	32	EFA	9				
AreaSF/TLA	911 / 2,225	Exterior Walls	Sim Stn			Shower Stall/Tub		Condition	Excellent	EFF Year	1992				
Condition	Excel	Roof	Asph / Gable			Mtl St Sh Bath		Bsmt (SF)	32	Condition	Excel				
Basement	Full	Interior Finish	DRYWALL/HARDWOOD			Mtl Stall Shower		NoBsmt Flr(SF)		Bsmt (SF)					
No Bsmt Flr.	0	Flooring	CONCRETE-SOFTWOOD			No Bathroom		Heat	Yes	Qtrs Over	Frame				
Heat	Yes	Non-base Heating		Fireplace		Wet Bar		AC	Yes	Qtrs Over (SF)	161				
AC	Yes	Floor/Wall #	0			Whirlpool Bathroom		Attic (SF)		Qtrs AC (SF)					
Attic	None	Pipeless #	0			Whirlpool Tub		See other pages for more additions.							
		Hand Fired (Y/N)	No			No Hot Water Tank									
		Space Heat #	0			No Plumbing									
		Appliances				No Sewer & Water Only									
		Range Unit	Intercom System			Water Only w/Sink									
		Oven Unit	Intercom w/Music			Hot Tub									
		Dishwasher	1	Built-In Stereo		Water Only									
		Microwave	BI Stereo(SpkrsOnly)			No Tub / Shower									
		Trash Compactor	Security System			Urinal									
		Jennair				Bidet									
		B.I. Bar-B-Que				Fbgls Service Sink									
		Built-In Vacuums													

Bldg / Addn	Description	Units	Year
1 of 1	101 — Single-Family / Owner Occupied		
	2 Story Frame	911	
	Base Heat		
	Add Central Air	911	
#1	Porch: 1S Frame Open	40 SF	
#2	Porch: 1S Frame Open	64 SF	
	Veneer #1 1 Story Brick	10.0 LF	
	Plumbing	3	
	B.I. Appliances	1	
	Garage: Att Frame	469 SF	1992
1 of 3 Adtn	1 Story Frame	32 SF	1992
2 of 3 Adtn	1 Story Frame	192 SF	1992
3 of 3 Adtn	1 Story Frame	18 SF	1992

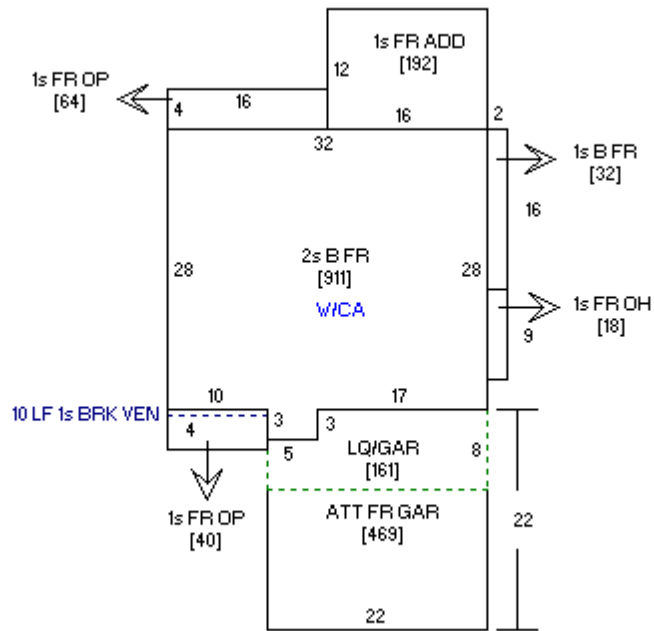

Sketch 1 of 1

