

LEGAL DESCRIPTION:

CLASS:

30-91-37
ALTA WASHINGTON
AUD S/D SW FR 1/4
LOT 26 & PARCEL 5' X
100' ADJ. TO LOT 26

R RESIDENTIAL

-----		CSR'S	.00	-----	
				CODE	VALUE ACRES
GROSS	CURRENT				
ROADS	LAND	40,090			
D.D.	BLDG				
R.R.	DWLG	222,410(1)			
MISC					
	TOTAL	262,500			
NET					

=====		=====		=====	
		YEAR	2007		
	LAND	40,090			
	BLDG				
	DWLG	222,410(1)			
	TOTAL	262,500			
	NET TX				

-----		-----		-----		-----	
DEED HOLDER:	DATE REFER	CONTRACT HOLDER:	DATE REFER	YEAR	2007		
DUNN RANDLE L	03072007 2			LAND	33,970		
DUNN DEBBRA A				BLDG			
26 ST ANDREWS DR				DWLG	188,480(1)		
STORM LAKE IA 50588				TOTAL	222,450		
				NET TX			

-----		-----		-----		-----	
				YEAR	2006		
PITSTICK JOY J TRUST	1			LAND	33,970		
				BLDG			
				DWLG	188,480(1)		
				TOTAL	222,450		
				NET TX			

-----		-----		-----		-----	
				YEAR	2005		
				LAND	33,970		
				BLDG			
				DWLG	188,480(1)		
				TOTAL	222,450		
				NET TX			

-----		-----		-----		-----	
REMARKS:				YEAR	2004		
1 W.D. 58/14 08-07-91 "TRUST"				LAND	33,970		
2 W.D. #070315 01-29-07 \$220,000 (D000)				BLDG			
				DWLG	188,480(1)		
				TOTAL	222,450		
				NET TX			

-----		-----		-----		-----	
				YEAR	2003		
				LAND	33,970		
				BLDG			
				DWLG	188,480(1)		
				TOTAL	222,450		
				NET TX	2,688		

PDF+PIN: 003+10-30-351-002 Deed: **DUNN RANDLE L,DUNN DEBBRA A** Map Area: **261 LAKE CREEK** Checks/Tags:
 Address: **26 ST ANDREWS DR** Contract: Route: **000-000-000** Lister/Date: **KMC, 06/18/1986**
 City: **ALTA** CID#: **0980100** Tax Dist: **ALTA** Review/Date:
RURAL/RESIDENTIAL DBA: Plat Page: - Entry Status: **Inspected**
 Legal: 30-91-37 ALTA WASHINGTON AUD S/D SW FR 1/4 LOT 26 & PARCEL 5' X 100' ADJ. TO LOT 26

Land										
Land Basis	Front	Rear	Side 1	Side 2	R. Lot	SF	Acres	Depth Factor	EFF	Qual./Land
FF Main	100.00	100.00	170.00	170.00	0.00			1.08	108.00	R-280
Sub Total						17,000.00	0.390			
Grand Total						17,000.00	0.390			

Sales				Building Permits				Values			
Date	\$ Amount	NUTC	Recording	Date	Number	Tag	\$ Amount	Reason			
01/29/2007	\$220,000	D000	070315								

Res. Structure		Finish				Plumbing		Addition		Garage	
Occ. Code	101	Ttl Rooms Above #	16	Bedrooms Above #	3	Full Bath	2	Addition	No Additions	Garage	1 of 1
Occ. Descr.	Single-Family / Owner Occupied	Ttl Rooms Below #	0	Bedrooms Below #	0	Shower Stall Bath		Year Built		Style	Att Brick
Year Built	1984	Bsmt Fin Area #1				Toilet Room		EFA		W X L	0' X 0'
EFA / EFYr	17 / 1984	Bsmt Fin Area #2				Lavatory	1	EFA Year		Area (SF)	504
Arch. Dsgn	N/A	Bsmt Fin Area #3				Water Closet		Style		Year Built	1984
Style	1 Story Brick	Foundation	C Blk			Sink	2	Area (SF)		EFA	17
AreaSF/TLA	2,428 / 2,428	Exterior Walls	Brk			Shower Stall/Tub		Condition		EFF Year	1984
Condition	V Good	Roof	Slate / Hip			Mtl St Sh Bath		Bsmt (SF)		Condition	V Good
Basement	None	Interior Finish	DRYWALL/SOFTWD			Mtl Stall Shower		NoBsmt Flr(SF)		Bsmt (SF)	
No Bsmt Flr.	0	Flooring	Carp			No Bathroom		Heat		Qtrs Over	None
Heat	Yes	Non-base Heating		Fireplace		Wet Bar		AC		Qtrs Over (SF)	
AC	Yes	Floor/Wall #	0	Masonry, 1 Sty	1	Whirlpool Bathroom		Attic (SF)		Qtrs AC (SF)	
Attic	None	Pipeless #	0			Whirlpool Tub					
		Hand Fired (Y/N)	No			No Hot Water Tank					
		Space Heat #	0			No Plumbing					
		Appliances				Sewer & Water Only				Door Opnrs	2
		Range Unit	1	Intercom System		Water Only w/Sink				Bsmt Stalls	
		Oven Unit	1	Intercom w/Music		Hot Tub	1				
		Dishwasher	1	Built-In Stereo		Water Only					
		Microwave		BI Stereo(SpkrsOnly)		No Tub / Shower					
		Trash Compactor		Security System		Urinal					
		Jennair				Bidet					
		B.I. Bar-B-Que				Fbgl Service Sink					
		Built-In Vacuums									



Bldg / Addn	Description	Units	Year
1 of 1	101 — Single-Family / Owner Occupied		
	1 Story Brick	2,428	
	Adjustment for basement - None		
	Add Central Air	2,428	
#1	Porch: 1S Brick Open	36 SF	
#2	Porch: 1S Frame Open	94 SF	
	Deck #1: Concrete Patio-Med	864 SF	
	Plumbing	6	
	B.I. Appliances	3	
#1	Fireplace: Masonry, 1 Story	1	
	Garage: Att Brick	504 SF	1984

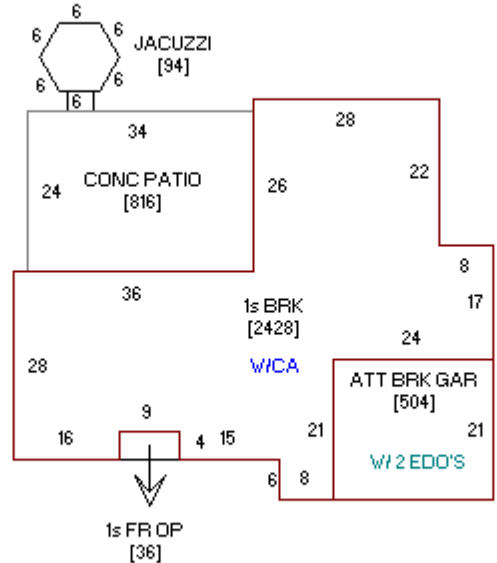

Sketch 1 of 1

