

LEGAL DESCRIPTION:

CLASS:

-----		CSR'S	.00	-----	
				CODE	VALUE ACRES
GROSS	CURRENT				
ROADS	LAND	11,040			
D.D.	BLDG				
R.R.	DWLG	39,320(1)			
MISC					
	TOTAL	50,360			
NET					

29-00 R RESIDENTIAL
 ALTA WASHINGTON
 LAKE CREEK VILLA 1
 #105-U

=====		=====	=====	=====	
	YEAR	2006			
	LAND	11,040			
	BLDG				
	DWLG	39,320(1)			
	TOTAL	50,360			
	NET TX				

-----		DEED HOLDER:	DATE REFER	CONTRACT HOLDER:	DATE REFER	YEAR	2005	-----	
						LAND	11,040		
		SMITH BARTON J	07112006 1			BLDG			
		SMITH KELLI C				DWLG	39,320(1)		
		105 VILLA RD				TOTAL	50,360		
		ALTA IA 51002				NET TX			

-----		-----	-----	-----	-----	YEAR	2004	-----	
						LAND	11,040		
		LARSON KARL L	02282002 6			BLDG			
		105 VILLA RD				DWLG	39,320(1)		
		ALTA IA 51002				TOTAL	50,360		
						NET TX			

-----		-----	-----	-----	-----	YEAR	2003	-----	
						LAND	11,040		
		105 VILLA RD				BLDG			
		ALTA IA				DWLG	39,320(1)		
		STONER MATTHEW R	4			TOTAL	50,360		
		STONER MELINDA J				NET TX	530		
		105 VILLA RD							
		ALTA IA							

-----		REMARKS:	-----	YEAR	2003	-----	
				LAND	10,320		
				BLDG			
		1 W.D. #061836 06-21-06 \$54,000 (D008)		DWLG	36,750(1)		
		4 W.D. 61/681 07-31-96 \$43,000 (D008)		TOTAL	47,070		
		5 W.D. #984324 11-13-98 \$44,050 (D008)		NET TX	530		
		6 W.D. #020159 01-15-02 \$51,500 (D008)					

-----		YEAR	2002	-----	
		LAND	10,320		
		BLDG			
		DWLG	36,750(1)		
		TOTAL	47,070		
		NET TX	468		

Property Record Card

WORKING

Buena Vista County Assessor

Tue, 7/25/2006, 10:49 AM Page 1

PDF+PIN: 003+10-30-301-005

Deed: **SMITH BARTON J,SMITH KELLI C**

Map Area: **261 LAKE CREEK**

Checks/Tags:

Address: **105 VILLA RD**

Contract:

Route: **000-000-000**

Lister/Date: **KMC, 01/01/1990**

City:

CID#: **0982200**

Tax Dist: **ALTA**

Review/Date:

RURAL/RESIDENTIAL

DBA:

Plat Page: -

Entry Status: **Inspected**

Legal: 29-00 ALTA WASHINGTON LAKE CREEK VILLA 1 #105-U

Land

Land Basis	Front	Rear	Side 1	Side 2	R. Lot	SF	Acres	Depth Factor	EFF	Qual./Land
FF Main	35.00	35.00	150.00	150.00	0.00			1.04	36.40	R-270
Sub Total						5,250.00	0.121			
Grand Total						5,250.00	0.121			

Sales

Building Permits

Values

Date	\$ Amount	NUTC	Recording	Date	Number	Tag	\$ Amount	Reason
06/21/2006	\$54,000	D008	061836					
01/15/2002	\$51,500	D008	#020159					
11/13/1998	\$44,050	D008	#984324					
08/01/1997	\$39,000	D008	061-341					

Res. Structure 1 of 1

Finish

Plumbing

Addition

Garage

Occ. Code	113	Ttl Rooms Above #	4	Bedrooms Above #	2	Full Bath	1	Addition	No Additions	Garage	1 of 1
Occ. Descr.	Condominium	Ttl Rooms Below #	0	Bedrooms Below #	0	Shower Stall Bath		Year Built		Style	Det Frm
Year Built	1973	Bsmt Fin Area #1				Toilet Room	1	EFA		W X L	14' X 22'
EFA / EFYr	28 / 1973	Bsmt Fin Area #2				Lavatory		EFA Year		Area (SF)	308
Arch. Dsgn	N/A	Bsmt Fin Area #3				Water Closet		Style		Year Built	1973
Style	1 Story Frame	Foundation	C Bk			Sink		Area (SF)		EFA	28
AreaSF/TLA	1,005 / 1,005	Exterior Walls	BRICK VANNER			Shower Stall/Tub		Condition		EFF Year	1973
Condition	NML	Roof	Asph / Gable			Mtl St Sh Bath					
Basement	None	Interior Finish	DRYWALL/HARDWOOD			Mtl Stall Shower		Bsmt (SF)		Condition	NML
No Bsmt Flr.	0	Flooring	Carp / Hwd			No Bathroom		NoBsmt Flr(SF)		Bsmt (SF)	
Heat	Yes	Non-base Heating		Fireplace		Wet Bar		Heat		Qtrs Over	None
AC	Yes	Floor/Wall #	0			Whirlpool Bathroom		AC		Qtrs Over (SF)	
Attic	None	Pipeless #	0			Whirlpool Tub		Attic (SF)		Qtrs AC (SF)	
		Hand Fired (Y/N)	No			No Hot Water Tank					
		Space Heat #	0			No Plumbing				Door Opnrs	
		Appliances				Sewer & Water Only				Bsmt Stalls	
		Range Unit	1	Intercom System		Water Only w/Sink					
		Oven Unit	1	Intercom w/Music		Hot Tub					
		Dishwasher	1	Built-In Stereo		Water Only					
		Microwave		BI Stereo(SpkrsOnly)		No Tub / Shower					
		Trash Compactor		Security System		Urinal					
		Jennair				Bidet					
		B.I. Bar-B-Que				Fbgl Service Sink					
		Built-In Vacuums									



Copyright © 1997-2006
Vanguard Appraisals, Inc.

Bldg / Addn	Description	Units	Year						
1 of 1	113 — Condominium								
	1 Story Frame	1,005							
	Adjustment for basement - None								
	Add Central Air	1,005							
	Deck #1: Wood Deck-Med	72 SF							
	Plumbing	2							
	B.I. Appliances	3							
BEx	1/8TH COMMON AREA	126 SF							
	Garage: Det Frame	14' X 22'	308 SF	1973					

	Description	Units	Year							
P:0	Yrd 1 — 2-12 X 22 ASSOC GAR(1/20th) Quantity= 1, Units=N/A, Height= 0		1973							

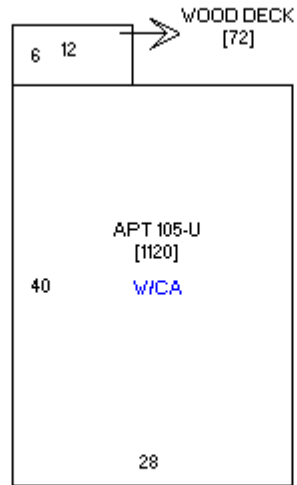

Sketch 1 of 1



Photo 1 of 1