

Pin: 05-27-200-005
Sale Date: 11/15/06
Sale Price: \$31,500
Net Acres: 2.26
Classification: Residential
Sale Code: Sale by lending
institution that acquired the
property by sheriff's sale

05-27-200-005

11255.25

R-Res

E
↑

#8-Mobile Home
@ NV



LEGAL DESCRIPTION:

CLASS:

27-92-38 R RESIDENTIAL
ALTA ELK
2.57 AC IN SE NE

		CSR'S	.00		
				CODE	VALUE ACRES
GROSS	2.57	CURRENT			
ROADS	.31	LAND	17,440		
D.D.		BLDG			
R.R.		DWLG	20,630(1)		
MISC					
		TOTAL	38,070		
NET	2.26				

		YEAR	2006		
		LAND	17,440	ROAD	.31
		BLDG			
		DWLG	20,630(1)		
		TOTAL	38,070		
		NET TX			

DEED HOLDER:	DATE REFER	CONTRACT HOLDER:	DATE REFER	YEAR	2005		
WEILAND CORY DELL	01242007 1			LAND	17,440	ROAD	.31
WEILAND MELINDA LUCILLE				BLDG			
5326 100TH AVE				DWLG	20,630(1)		
STORM LAKE IA 50588				TOTAL	38,070		
				NET TX			

		YEAR	2004		
DEUTSCHE BANK NATIONAL TRUST COMPANY	10272006 6	LAND	17,440		
		BLDG			
		DWLG	20,630(1)		
		TOTAL	38,070		
		NET TX			

		YEAR	2003		
PETERSON FRANK	09292003 5	LAND	17,440		
PETERSON KAREN		BLDG			
5245 50TH AVE		DWLG	20,770(1)		
ALTA IA 51002		TOTAL	38,210		
		NET TX	380		

		YEAR	2003		
PETERSON FRANK L	4	LAND	16,300		
		BLDG			
		DWLG	19,410(1)		
		TOTAL	35,710		
		NET TX	380		

		YEAR	2002		
REMARKS:		LAND	16,300		
		BLDG			
1 W.D. #063459 11-15-06 \$31,500 (D000)		DWLG	19,410(1)		
4 W.D. #993375 10-07-99 \$45,000 (D000)		TOTAL	35,710		
6 SHERIFF #062772 09-05-06 \$41,600		NET TX	380		

		YEAR	2002		
		LAND	16,300		
		BLDG			
		DWLG	19,410(1)		
		TOTAL	35,710		
		NET TX	332		

PDF+PIN: 003+05-27-200-005 Deed: **WEILAND CORY DELL,WEILAND MELINDA LUCILLI** Map Area: **210 ALTA ELK** Checks/Tags:
 Address: **5245 50TH AVE** Contract: Route: **000-000-000** Lister/Date: **CVH, 11/26/1986**
 City: **ALTA** CID#: **1125525** Tax Dist: **ALTA** Review/Date:
RURAL/RESIDENTIAL DBA: Plat Page: Entry Status: **Inspected**
 Legal: 27-92-38 ALTA ELK 2.57 AC IN SE NE

Land											
Land Basis	Front	Rear	Side 1	Side 2	R. Lot	SF	Acres	Depth Factor	EFF	Qual./Land	
Acre X Rate						43,560.00	1.000			AC-6	
Acre X Rate						54,885.60	1.260			AC-4	
Grand Total						98,445.60	2.260				

Sales				Building Permits				Values			
Date	\$ Amount	NUTC	Recording	Date	Number	Tag	\$ Amount	Reason			
11/15/2006	\$31,500	D045	063459								
09/05/2006	\$41,600	D006	062772								
03/12/2003	\$0	D001	#034193								
07/10/1999	\$45,000	D000	#993375								

Res. Structure		Finish				Plumbing		Addition		Garage	
Occ. Code	101	Ttl Rooms Above #	42	Bedrooms Above #	0	Full Bath	1	Addition	1 of 2	Garage	1 of 1
Occ. Descr.	Single-Family / Owner Occupied	Ttl Rooms Below #	0	Bedrooms Below #	0	Shower Stall Bath		Year Built	1900	Style	Det Frm
Year Built	1900	Bsmt Fin Area #1				Toilet Room		EFA	101	W X L	12' X 24'
EFA / EFYr	101 / 1900	Bsmt Fin Area #2				Lavatory		EFA Year	1900	Area (SF)	288
Arch. Dsgn	N/A	Bsmt Fin Area #3				Water Closet		Style	1 Sty Frm	Year Built	1910
Style	1 1/2 Story Frame	Foundation	Str			Sink		Area (SF)	348	EFA	91
AreaSF/TLA	336 / 1,227	Exterior Walls	Asph Shgls			Shower Stall/Tub		Condition	Poor	EFF Year	1910
Condition	Poor	Roof	Wd / Gable			Mtl St Sh Bath		Bsmt (SF)		Condition	BL NML
Basement	1/2	Interior Finish	Plas / Panel			Mtl Stall Shower		NoBsmt Flr(SF)		Bsmt (SF)	
No Bsmt Flr.	0	Flooring	EARTH-SOFTWOOD-SOFTWOOD			No Bathroom		Heat	Yes	Qtrs Over	None
Heat	Yes	Non-base Heating		Fireplace		Wet Bar		AC	No	Qtrs Over (SF)	
AC	No	Floor/Wall #	0			Whirlpool Bathroom		Attic (SF)		Qtrs AC (SF)	
Attic	None	Pipeless #	0			Whirlpool Tub		See other pages for more additions.			
		Hand Fired (Y/N)	No			No Hot Water Tank				Door Opnrs	
		Space Heat #	0			No Plumbing				Bsmt Stalls	
		Appliances				Sewer & Water Only					
		Range Unit		Intercom System		Water Only w/Sink					
		Oven Unit		Intercom w/Music		Hot Tub					
		Dishwasher		Built-In Stereo		Water Only					
		Microwave		BI Stereo(SpkrsOnly)		No Tub / Shower					
		Trash Compactor		Security System		Urinal					
		Jennair				Bidet					
		B.I. Bar-B-Que				Fbgl Service Sink					
		Built-In Vacuums									



Bldg / Addn	Description	Units	Year					
1 of 1	101 — Single-Family / Owner Occupied							
	1 1/2 Story Frame	336						
	Adjustment for basement - 1/2							
#1	Porch: 1S Frame Enclosed	60 SF						
1 of 2 Adtn	1 Story Frame	348 SF	1900					
2 of 2 Adtn	1 Story Frame	308 SF	1900					
	Garage: Det Frame 12' X 24'	288 SF	1910					

	Count	Ag Building Description	Units	Year						
1 of 4 P:2	1	HOG HSE FR J@J .40 927—Shed	20' X 32' 640 SF	1900						
2 of 4 P:3	1	FEED L FR @ .40 907—Barn - Feed and Livestocl	54' X 56' 3,024 SF	1900						
3 of 4 P:5	1	MACH MTL @ .70 927—Shed	26' X 52' 1,352 SF	1900						
4 of 4 P:6	1	DBL FR @ .70 926—Crib	26' X 28' 728 SF	1900						

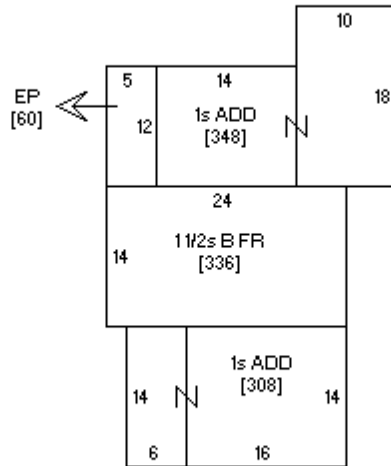

Sketch 1 of 1