

Pin:10-30-302-022  
Sale Date: 12/24/03  
Sale Price: \$135,000  
Acres:lot 100'x170'

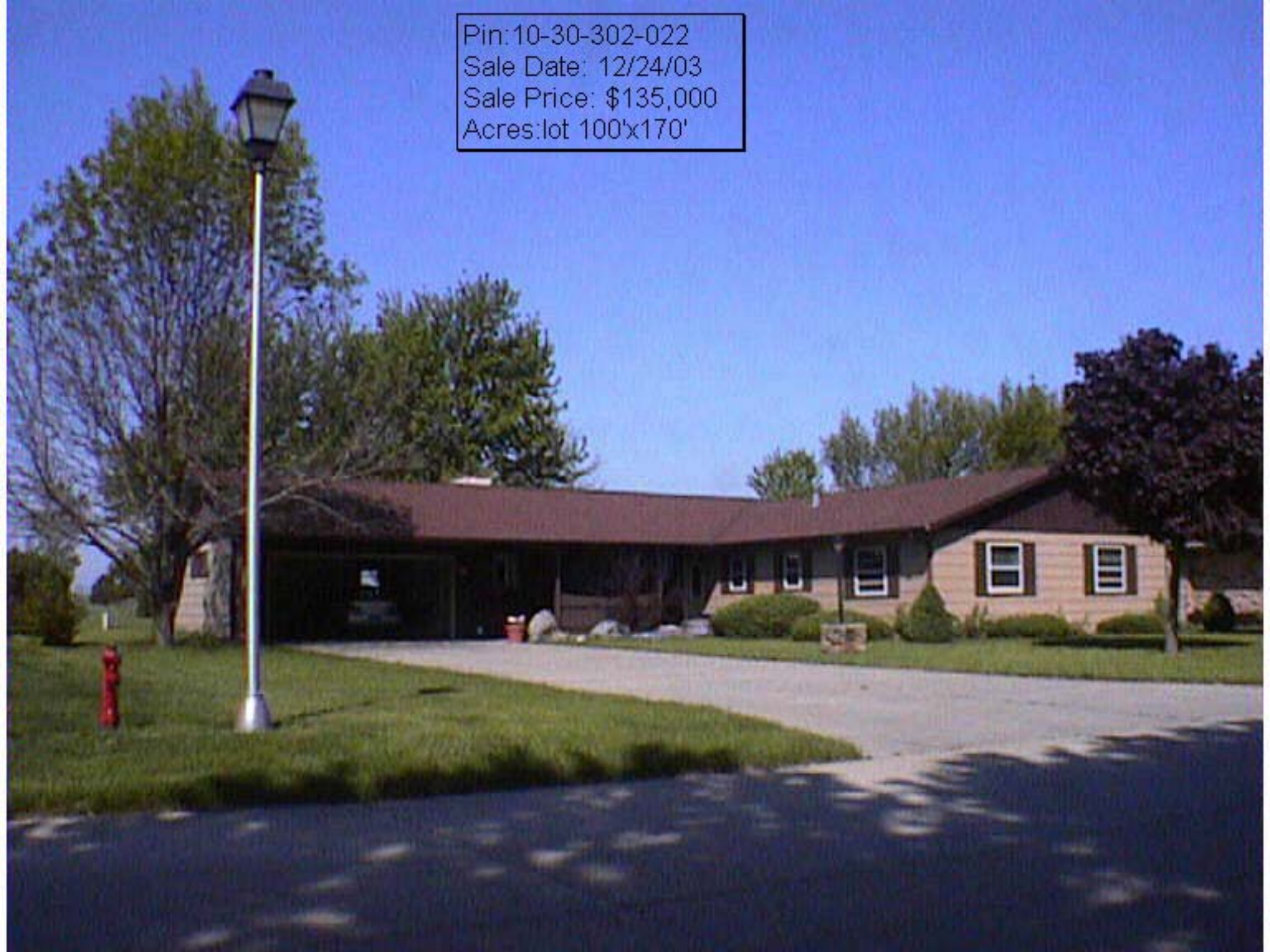

LOCATION: 24 ST ANDREWS DR  
 LEGAL DESCRIPTION:

DISTRICT: 00260 REF #:

PARCEL #: 10-30-302-022 ALT ID: 0000979900

CLASS:

30-91-37  
 ALTA WASHINGTON  
 AUD S/D SW FR 1/4  
 LOT 24 & PARCEL 5' X  
 100' ADJ. TO LOT 24

R RESIDENTIAL

	CSR'S	.00	CODE	VALUE	ACRES
GROSS	CURRENT				
ROADS	LAND	33,970			
D.D.	BLDG				
R.R.	DWLG	130,960( 1)			
MISC					
	TOTAL	164,930			
NET					

YEAR	2003
LAND	33,970
BLDG	
DWLG	130,960( 1)
TOTAL	164,930
NET TX	

DEED HOLDER: DATE REFER  
 SMITH TIMOTHY J 01272004 5  
 SMITH ERIN M  
 24 ST ANDREWS DR  
 ALTA IA

CONTRACT HOLDER: DATE REFER

YEAR	2003
LAND	31,750
BLDG	
DWLG	122,390( 1)
TOTAL	154,140
NET TX	

JENSEN NANCY C 02132002 4  
 139 MALLARD  
 STORM LAKE IA

YEAR	2002
LAND	31,750
BLDG	
DWLG	122,390( 1)
TOTAL	154,140
NET TX	1,748

JOHNSON NANCY C 09112000 3  
 24 ST ANDREWS DR  
 STORM LAKE IA

YEAR	2001
LAND	31,750
BLDG	
DWLG	122,390( 1)
TOTAL	154,140
NET TX	1,658

MOUW JOHN T 10021996 2  
 MOUW JUDIE E  
 24 ST ANDREWS DR  
 STORM LAKE IA

YEAR	2000
LAND	16,690
BLDG	
DWLG	94,270( 1)
TOTAL	110,960
NET TX	1,186

REMARKS:

- 2 W.D. 61/751 09-19-96 \$129,000 (D000)
- 3 W.D. #002392 08-30-00 \$156,000(D000)
- 4 AFFIDAVIT #020024 01-03-02
- 5 W.D. #035536 12-24-03 \$135,000 (D000)

YEAR	1999
LAND	16,690
BLDG	
DWLG	94,270( 1)
TOTAL	110,960
NET TX	1,198

PDF 3: 09799-00 / [?] LAKE CREEK / 000-00-000  
 Map Area: 261 LAKE CREEK Loc./Class: RURAL/RESIDENTIAL Tax Dist.: ALTA

	Sale Date	Sale Amt.	Code	Book/Page	Permit	\$-Amount	Reason	Year
CID#.....: [?]	10/11/1979	\$ 75,000	D000	[?]				

Entry.....: Inspected List/Review  
 Insp. Date.: 06/19/1986 KMC/?  
 Building #... 1 of 1 Exempt: No  
 DBA.....: [?]  
 101 SINGLE-FAMILY/OWNER OCCUPIED Plat: -

LAND SUMMARY

BASIS..... [ Std Dimensions ]  
 Main-Lot  
 -----  
 Frontage.: 100.00  
 Rear.....: 100.00  
 Side-1...: 170.00  
 Side-2...: 170.00  
 Rear-Lot.: 0.00  
 D-Factor.: 1.08  
 EFF.....: 108.00

General Notes:

===== IMPROVEMENT DATA =====  
 BUILDING...: 1.00 Story Frame / 6 Rooms / 3 BedRooms / 1812 SF / Built: 1977 / EX  
 : No Bsmt / Unfinished Bsmt / AC / Attic: None

FINISH....: FOUNDATION: CONCRETE BLOCK DECK/PATIO: 676 SF-PATIO CONC-LOW FIREPLACE.: 1 Prefab ( 1-Sty )  
 EXTERIOR..: SIDING ON SHEATHING 676 SF-CANOPY-MED  
 ROOF.....: GABLE/ASPHALT  
 INTERIOR..: DRYWALL/MAHOGONY  
 FLOORING..: CARPET

PORCHES...: 252 SF / 1 St Frm Opn / No Bsmt  
 : 176 SF / 1 St Frm Enc / No Bsmt

PLUMBING..: 1-FULL BATH 1-SHOWER STALL BATH 1-TOILET ROOM 1-SINK

BUILT INs.: 1-DISHWASHER

GARAGE....: 528 SF Attached (Frame)

