

Pin: 10-30-301-002
Sale Date: 06/20/03
Sale Price: \$50,000
On Lake Creek Golf Course

108U
104L

107U
103L

106U
102L

105U
101L

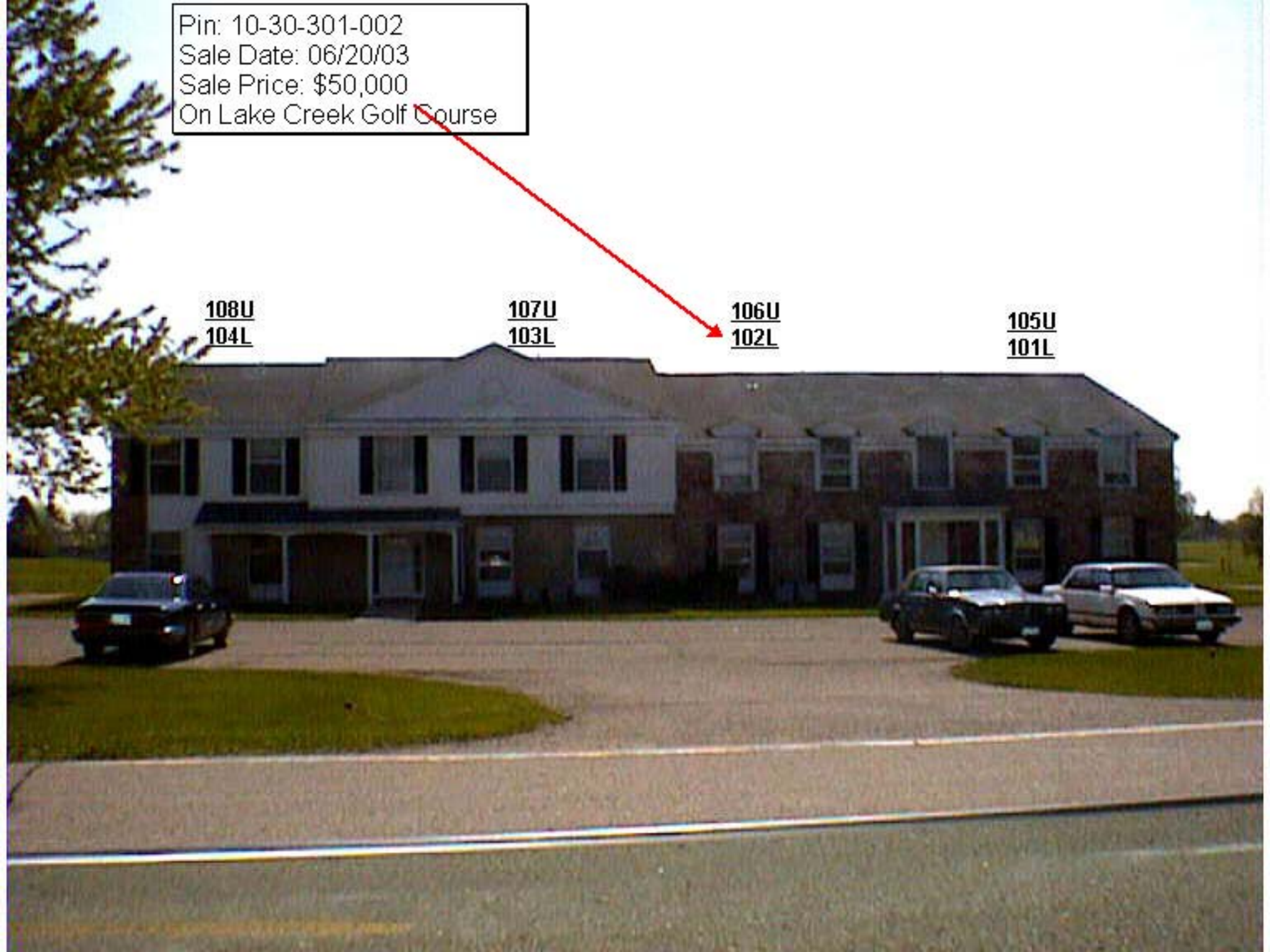

PDF 3: 09819-00 / [?] LAKE CREEK APT 102 L / 000-00-000
 Map Area: 261 LAKE CREEK Loc./Class: RURAL/RESIDENTIAL Tax Dist.: ALTA

	Sale Date	Sale Amt.	Code	Book/Page	Permit	\$-Amount	Reason	Year
CID#.....: [?]	05/12/1989	\$ 25,000	D000	056-532				
Entry.....: Inspected List/Review	04/01/1977	\$ 27,550	C000	[?]				
Insp. Date.: 00/00/0000 KMC/?								
Building #... 1 of 1 Exempt: No								
DBA.....: [?]								
113 CONDOMINIUM								

Plat: -

LAND SUMMARY

BASIS....: [Std Dimensions]

Main-Lot

Frontage..:	35.00
Rear.....:	35.00
Side-1...:	150.00
Side-2...:	150.00
Rear-Lot.:	0.00
D-Factor.:	1.04
EFF.....:	36.39

General Notes:

IMPROVEMENT DATA

BUILDING...: Unique / 4 Rooms / 2 BedRooms / 1120 SF / Built: 1973 / NML
 : No Bsmt / Unfinished Bsmt / AC / Attic: None

FINISH....: FOUNDATION: CONC BLK DECK/PATIO: 72 SF-PATIO CONC-LOW
 EXTERIOR...: BRK VENEER
 ROOF.....: GABLE\ASPHALT
 INTERIOR...: DRYWALL\HARDWD
 FLOORING..: HARDWD\CARPET

PLUMBING...: 1-FULL BATH 1-TOILET ROOM
 BUILT INS.: 1-RANGE UNIT 1-OVEN UNIT 1-DISHWASHER

Item	Yard Extras:	Description	Qty	Units
1.	MISC. EXTRA	GARAGE (308)	308	SF
2.	MISC. EXTRA	STORAGE AREA	1	N/A

VALUE SUMMARY

