

Rural Res - 9.39 Acres

PIN: 06-28-400-003
Sale Date: 07/30/02
Sale Price: \$82,000

9986.25

E
↑



PDF+PIN: 003+06-28-400-003 Deed: GONZALEZ JOSE MARTIN/GONZALEZ FRANCES Map Area: 170 ACT SCOTT Checks/Tags:
 Address: 5257 100TH AVE Contract: Route: 000-000-000 Lister/Date: CVH, 08/06/1986
 City: CID#: 0998625 Tax Dist: A.C.T. Review/Date: --, 05/15/1995
 RURAL/RESIDENTIAL DBA: Plat Page: - Entry Status: Inspected
 Legal: 28-92-37 A.C.T. SCOTT PT. NE SE (708.3' X 615')

Land											
Land Basis	Front	Rear	Side 1	Side 2	R. Lot	SF	Acres	Depth Factor	EFF	Qual./Land	
Acres X Rate						43,560.00	1.00			AC-5	
Acres X Rate						365,468.40	8.39			AC-1	
Grand Total						409,028.40	9.39				

Sales				Building Permits				Values					
Date	\$ Amount	NUTC	Recording	Date	Number	\$ Amount	Reason						
2/22/2000	\$70,000	D045	#000476	See Picture for Current Sales Information									
12/1/1999	\$0	D006	#993893										
4/28/1995	\$84,000	D000	060-848										
4/15/1980	\$65,000	D000											

Res. Structure 1 of 1		Finish				Plumbing		Addition		Garage	
Occ. Code	101	Ttl Rooms Above #	33	Bedrooms Above #	0	Full Bath	2	Addition	1 of 1	Garage	No garages
Occ. Descr.	Single-Family / Owner Occupied	Ttl Rooms Below #	0	Bedrooms Below #	0	Shower Stall Bath		Year Built	1900	Style	
Year Built	1900	Bsmt Fin Area #1				Toilet Room		EFA	56	W X L	
EFA / EFYr	56 / 1945	Bsmt Fin Area #2				Lavatory		EFA Year	1945	Area (SF)	
Arch Dsgn	N/A	Bsmt Fin Area #3				Water Closet		Style	1 Story Frm	Year Built	
Style	2 Story Frame	Foundation	POURED CONCRETE			Sink		Area (SF)	462	EFA	
AreaSF/TLA	528 / 1,518	Exterior Walls	Other			Shower Stall/Tub		Condition	Above Normal	EFF Year	
Condition	Above Normal	Roof	Asph / Gable			Mtl St Sh Bath		Bsmt (SF)		Condition	
Basement	1/2	Interior Finish	PLASTER/SOFT-PLAST/SOFT			Mtl Stall Shower		NoBsmt Fir(SF)		Bsmt (SF)	
No Bsmt Fir	0	Flooring	None			No Bathroom		Heat	Yes	Qtrs Over	
Heat	Yes	Non-base Heating		Fireplace		Wet Bar		AC	No	Qtrs Over (SF)	
AC	No	Floor/Wall #	0	Prefab. 1 Story	1	Whirlpool Bathroom		Attic (SF)		Qtrs AC (SF)	
Attic	None	Pipeless #	0			Whirlpool Tub					
		Hand Fired (Y/N)	No			No Hot Water Tank					
		Space Heat #	0			No Plumbing					
						Sewer & Water Only					
		Appliances				Water Only w/Sink					
		Range Unit	Intercom System			Hot Tub					
		Oven Unit	Intercom w/Music			Water Only					
		Dishwasher	Built-In Stereo			No Tub / Shower					
		Microwave	BI Stereo(SpkrOnly)			Urinal					
		Trash Compactor	Security System			Bidet					
		Jennair				Fbgls Service Sink					
		B.I. Bar-B-Que									
		Built-In Vacuums									

Bldg / Addn	Descriptio	Units	Year
1 of 1	101 — Single-Family / Owner Occupied		
	2 Story Frame	528	
	Adjustment for basement - 1/2		
#1	Porch: 1S Frame Enclosed	245 SF	
	Deck #1: Wood Deck-Med	384 SF	
	Plumbing	1	
#1	Fireplace: Prefab, 1 Story	1	
1 of 1	Adtn 1 Story Frm	462 SF	1900

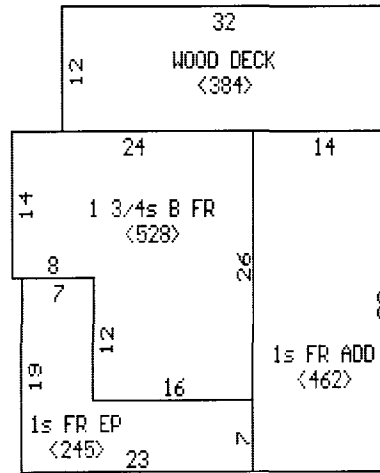

Count	Ag Building Description	Units	Price	Base Value	Grade	Year	Phys%	Fobs%	Eobs%	Ag Fctr%	Depreciated Total (Rnd nearest dollar)	Map	Appraised Value (Rnd nearest \$10)
1 of 5	DOG KENNEL CB												
Plot:1	927-Shed- 14' X 40'	560 SF	\$8.60	\$4,816	4	1980	46.00	20	50	0	\$884	1.000	\$880
2 of 5	MACH FR @ .90		Sound Val										
Plot:2	927-Shed- 20' X 42'	840 SF		\$0	4	1900	0.00	0	0	0	\$756	N/A	\$760
3 of 5	MTL FR												
Plot:3	925-Steel Utility Building- 14' X 20'	280 SF	\$11.10	\$3,206	4	1977	35.00	20	50	0	\$708	1.000	\$710
4 of 5	DOG KENNEL CB												
Plot:4	927-Shed- 14' X 60'	840 SF	\$8.00	\$6,720	4	1983	46.00	20	50	0	\$1,233	1.000	\$1,230
5 of 5	FR @ NV		Sound Val										
Plot:5	927-Shed- 8' X 7'	56 SF		\$0	4	1900	0.00	0	0	0	\$0	N/A	\$0
Ag Buildings TOTAL Value													\$3,580