

LEGAL DESCRIPTION:

CLASS:

10-91-35
A.C.T. COON
LOT B IN SW SW

A AGRICULTURE

		CSR'S	482.00		
				CODE	VALUE ACRES
GROSS	6.28	CURRENT			
ROADS	.04	LAND	8,460		
D.D.		BLDG	21,120(8)		
R.R.		DWLG	97,270(1)		
MISC					
		TOTAL	126,850		
NET	6.24				

		YEAR	2009 REFER: 1		
		LAND	8,460		
		BLDG	21,120(8)		
		DWLG	97,270(1)		
		TOTAL	126,850		
		NET TX			

DEED HOLDER:	DATE REFER	CONTRACT HOLDER:	DATE REFER	YEAR	
MC CARTHY MATTHEW C	10292009 2			LAND	
MC CARTHY KAYLA R				BLDG	
2215 560TH ST				DWLG	
NEWELL IA 50568				TOTAL	
				NET TX	
RICHTER JOHN				YEAR	
				LAND	
209 LEROY PAULSON RD				BLDG	
NEWELL IA 50568				DWLG	
				TOTAL	
				NET TX	
				YEAR	
				LAND	
				BLDG	
				DWLG	
				TOTAL	
				NET TX	

REMARKS:	YEAR	
1 2009)SPLIT FROM -004 (10/29/09)	LAND	
2 WDJT #093154 09/21/09 \$250,000 (D026)	BLDG	
	DWLG	
	TOTAL	
	NET TX	
	YEAR	
	LAND	
	BLDG	
	DWLG	
	TOTAL	
	NET TX	

PDF+PIN: 010+12-10-300-007 Deed: **MC CARTHY MATTHEW C,MC CARTHY KAYLA R** Map Area: **COON-AG** Checks/Tags:
 Address **2215 560TH ST** Contract: Route: **912-001-220** Lister/Date: **DS, 09/30/2008**
 (Property) CID#: **0751300** Tax Dist: **ACT COON** Review/Date: **DS, 12/02/2008**
 City: **NEWELL** DBA: Plat Page: - Entry Status: **Estimated**
RURAL/AG DWELLING MLS: Subdiv: **[NONE]**
 Legal: 10-91-35 A.C.T. COON LOT B IN SW SW

No Land Dimensions Entered

Sales				Building Permits				Values				
Date	\$ Amount	NUTC	Recording	Date	Number	Tag	\$ Amount	Reason				
09/29/2009	\$250,000	D026	093154									

Res. Structure		Finish				Plumbing		Addition		Garage	
Occ. Code	101	Ttl Rooms Above #	5	Bedrooms Above #	3	Full Bath	1	Addition	1 of 2	Garage	1 of 1
Occ. Descr.	Single-Family / Owner Occupied	Ttl Rooms Below #	0	Bedrooms Below #	0	Shower Stall Bath		Year Built	1959	Style	Att Frm
Year Built	1959	Bsmt Fin Area #1				Toilet Room		EFA	50	W X L	0' X 0'
EFA / EFYr	50 / 1959	Bsmt Fin Area #2				Lavatory		EFA Year	1959	Area (SF)	650
Arch. Dsgn	N/A	Bsmt Fin Area #3				Water Closet	1	Style	1 Sty Frm	Year Built	1959
Style	1 Story Frame	Foundation	C Blk			Sink	1	Area (SF)	144	EFA	50
AreaSF/TLA	1,260 / 1,594	Exterior Walls	Vinyl			Shower Stall/Tub	1	Condition	Above Normal	EFF Year	1959
		Roof	Asph / Gable			Mtl St Sh Bath					
		Interior Finish	Drwl			Mtl Stall Shower		Bsmt (SF)		Condition	A NML
		Flooring	Carp / Vinyl			No Bathroom		NoBsmt Flr(SF)		Bsmt (SF)	
		Non-base Heating		Fireplace		Wet Bar		Heat	FHA - Gas	Qtrs Over	None
		Floor/Wall #	0	Gas/Elec-Side, 1 Sty	1	Whirlpool Bathroom		AC	Yes	Qtrs Over (SF)	
		Pipeless #	0			Whirlpool Tub		Attic (SF)		Qtrs AC (SF)	
		Hand Fired (Y/N)	No			No Hot Water Tank		See other pages for more additions.			
		Space Heat #	0			No Plumbing				Door Opnrs	
		Appliances				Sewer & Water Only				Bsmt Stalls	
Condition	A NML	Range Unit	1	Built-In Vacuums		Water Only w/Sink					
Basement	Full	Oven - Single	1	Intercom System		Hot Tub					
No Bsmt Flr.	0	Oven - Double		BI Stereo		Bidet					
Heat	FHA - Gas	Dishwasher	1			Fbgl Service Sink					
AC	Yes	Microwave				Urinal					
Attic	None	Trash Compactor				Sauna					
		Jennair				W'Pool Bath w/Shower					
		Security System				Water Only					
						No Tub/Shower					



Bldg / Addn	Description	Units	Year					
1 of 1	101 — Single-Family / Owner Occupied							
	1 Story Frame	1,260						
	Base Heat: FHA - Gas							
	Add Central Air	1,260						
#1	Porch: 1S Frame Open	60 SF						
	Deck #1: Wood Deck-Med	280 SF						
	Plumbing	4						
	B.I. Appliances	3						
#1	Fireplace: Gas/Elec-Side, 1 Story	1						
	Garage: Att Frame	650 SF	1959					
1 of 2 Adtn	1 Story Frame	144 SF	1959					
2 of 2 Adtn	1 Story Frame	190 SF	1959					

	Count	Ag Building Description	Units		Year					
1 of 10 P:1	1	MACH FR @ .90 927-Shed 24' X 64'	1,536 SF		1900					
2 of 10 P:2	1	FR @ .90 906-Barn - Flat 32' X 50'	1,600 SF		1900					
3 of 10 P:3	1	HOG HSE FR @ .90 927-Shed 24' X 48'	1,152 SF		1900					
4 of 10 P:4	1	HEN HSE FR @ .70 927-Shed 24' X 50'	1,200 SF		1900					
5 of 10 P:5	1	FINISH FR 918-Confinement - Pre-Cut 35' X 60'	2,100 SF		1981					
6 of 10 P:6	1	PIT TO #5 940-Concrete Pit - 6 Ft Depth 35' X 60'	2,100 SF		1992					
7 of 10 P:8	1	FARROW 918-Confinement - Pre-Cut 22' X 94'	2,068 SF		1979					
8 of 10 P:9	1	MTL FR LESTER 925-Steel Utility Bldg 55' X 70'	3,850 SF		1985					
9 of 10 P:12	1	FINISHING 918-Confinement - Pre-Cut 40' X 80'	3,200 SF		1993					
10 of 10 P:13	1	PIT TO #12 941-Concrete Pit - 8 Ft Depth 20' X 84'	1,680 SF		1993					

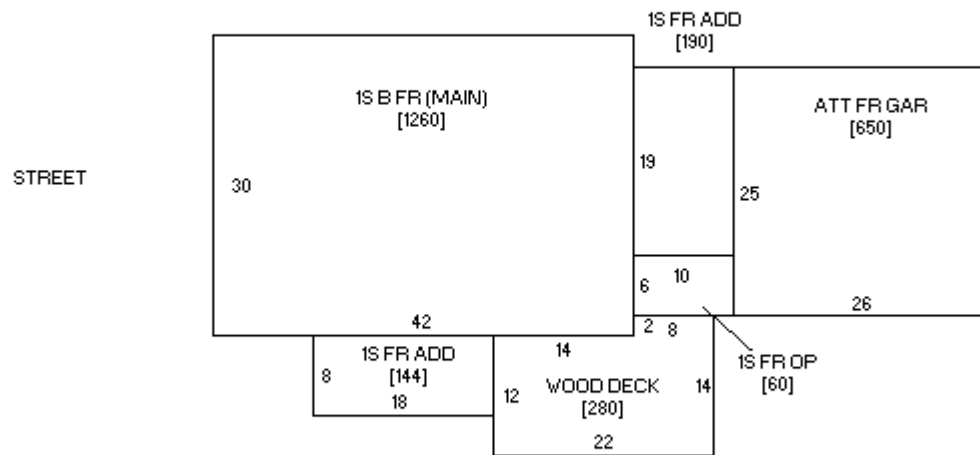



09/18/2008